

# SEWAGE MC

submersible pump for  
sewage water



waste water



industrial use

SEWAGE  
MC

**Max Head** 16 - 19m

**Max Flow** 57 - 60m<sup>3</sup>/h

**Motor Power** 2.2 - 3Kw

**Discharge size** 50 - 65



## KEY ADVANTAGES OF A MC PUMP

### APPLICATION

The electric pumps "MC" are particularly suitable for treatment of wastewater, industrial process water and raw sewage does not treated in municipal applications, public and industrial. The single-channel impeller permits passage of solids in the pump MC50 up to 50mm and at the pump MC65 up to 65mm, reducing the risk of clogging.

### INSTALLATION

Permanent or transportable.  
Single-Channel Impeller.

### MATERIALS

Double seals, lip seals and reinforced SIC-SIC mechanical seal. Motor casing, pump body and open impeller in cast iron, 420 stainless steel shaft.

### PUMPED LIQUID

Pumping of sewage and industrial water.  
Max. liquid temperature: 35°C.

### MOTOR

Fully submersible, pressure tight electric motor. Stainless steel motor- and pump housing. Insulation class F. Motor protection IP 68. Thermal sensors imbedded in the motor winding.

### FEATURES

Power cable: 20 m neoprene.  
Immersion depth of 10 m.  
Ideal for installation with guide rail.

# CHARACTERISTIC CURVES AND PERFORMANCE DATA

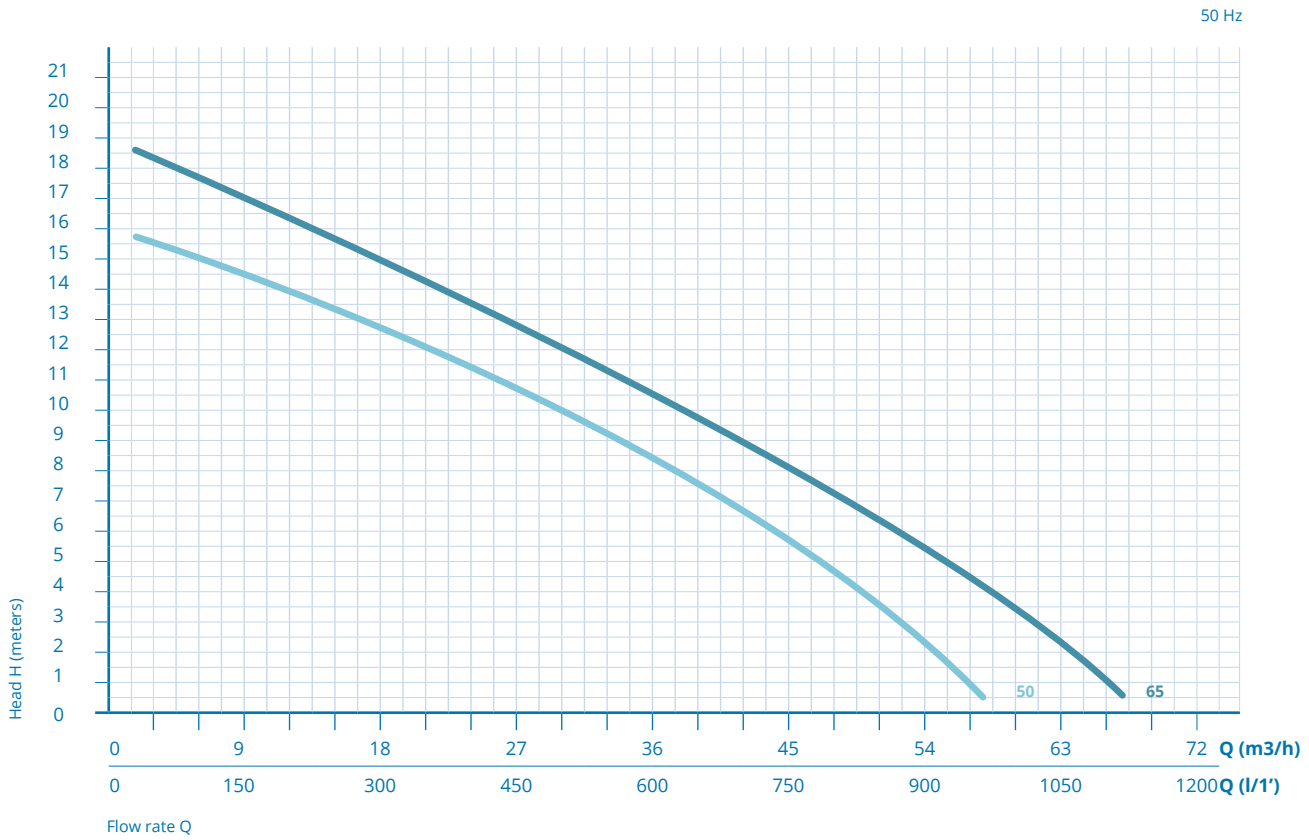

SEWAGE  
MC

TYPE	POWER kW	MOTOR		PORT DN	Q m <sup>3</sup> /h	0	9	15	18	21	24	30	36	42	48	54	60
		1~ A	μF			0	150	250	300	350	400	500	600	700	800	900	##
MC 50.220	2,2	4,2	-	50	H - meters	16	14,5	13,4	12,8	12,2	11,5	10	8,4	6,6	4,7	2,6	0,3
MC 65.300	3,0	4,8	-	65		19	17	15,7	15	14,2	13,5	12	10,3	8,6	6,8	4,9	2,9

## COMPONENTS AND MATERIALS

SEWAGE  
MC

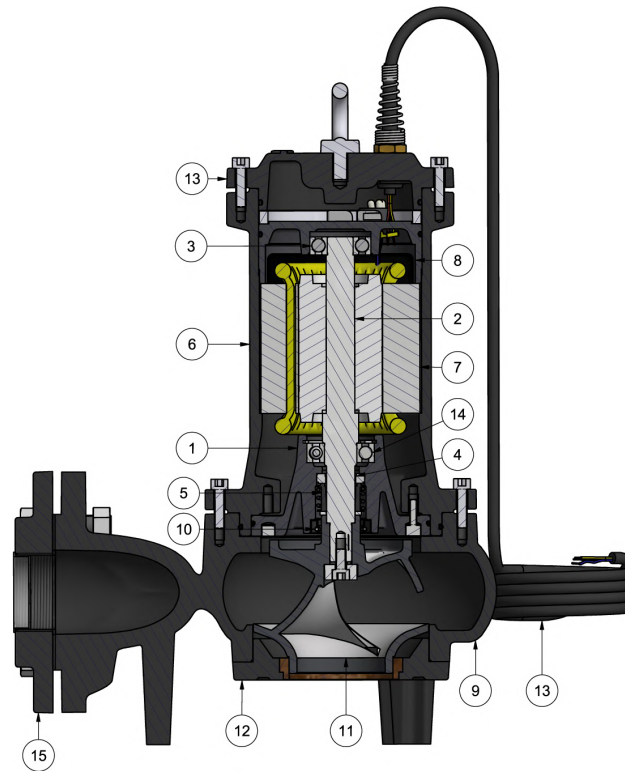

POS	COMPONENT	MATERIALS
1	Rotor Support	Cast Iron
2	Rotor / Shaft	Steel and Aluminium / Stainless Steel
3	Bearing	Steel
4	Mechanical Seal Fixe	Nitrile Rubber / Ceramics
5	Mechanical Seal Mobile	Graphite Steel
6	Motor Casing	Cast Iron
7	Stator	-
8	Top Engine Support	Cast Iron
9	Body Pump	Cast Iron
10	Lip Seals	Nitrile Rubber
11	Impeller	Cast Iron
12	Cover Impeller	Cast Iron
13	Power Cable	Neoprene
14	Bearing	Steel
15	Flange 2" - 2 ½"	Cast Iron

## DIMENSIONS AND WEIGHT

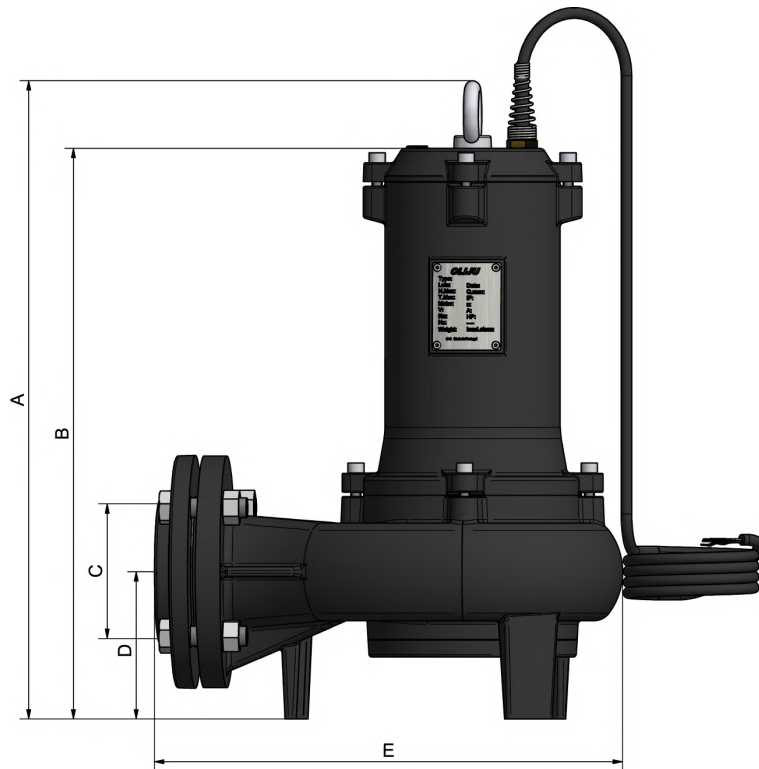

SEWAGE  
MC

TYPE	DIMENSIONS (mm)					WEIGHT Kg	PALETTE Un
	A	B	ØC	D	E		
MC 50.220	510	456	DN 50	118	372	45	75
MC 65.300			DN 65				