

SEWAGE GRINDER

submersible pump for sewage water



wastewater



domestic use

Vertical outlet

The range Grinder is designed for pumping sewage with solids and fibers, it is ideal for installation with guide raid.



KEY ADVANTAGES OF A GRINDER PUMP

The pump OLJU Ginder is a grinder pump system and is designed for applications of sewage with solids and fibers. The grinder system ensures that all the solids and fibers are broken in small pieces in order to pass in small tubes and passing the centrifugal pump without blocking the rotor.

The grinder system is easy to replace minimizing downtime the pump and making maintenance quick and easy.

USE

Water loaded with solids and fibers.
All wastewater from homes, including toilets.
Front outlet is ideal for installations with guide rail
immersion depth of 10m.

FEATURES

- Protection box in monophasic version;
- Grinder system, impeller in cast iron, stainless steel shaft, motor body inox on GR and cas iron on SGR;
- Engine oil bath class F;
- Double seals, lip seals and reinforced carbon ceramic mechanical seal;
- Single-phase models with ou without float (typeA).

CHARACTERISTIC CURVES AND PERFORMANCE DATA

50 Hz

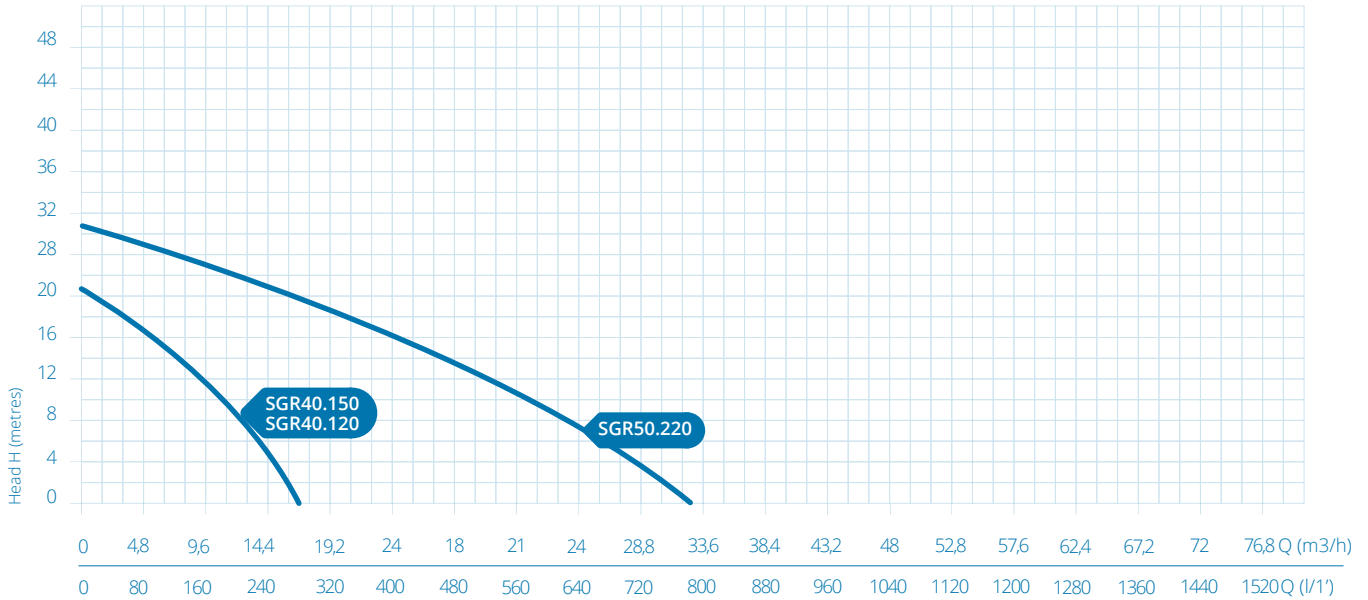

TYPE	POWER kW	MOTOR			PORT DN	Q	m³/h														
		1~ A	μF	3~ A			0	3	6	9	12	15	18	24	27	30	36	48	60	72	
SGR 40.150	1,5	7,2	35	-	1" ½	0	50	100	150	200	250	300	400	450	500	600	800	1000	1200		
SGR 40.120	1,2	-	-	2,1		21	20	18,8	17,4	15,9	14,2	10,3									
SGR 50.220	2,2	10	40	4,6	2	30	30,3	30,2	29,8	29,2	28,2	25,2	23,3	18,4	12,3	4,9					

COMPONENTS AND MATERIALS

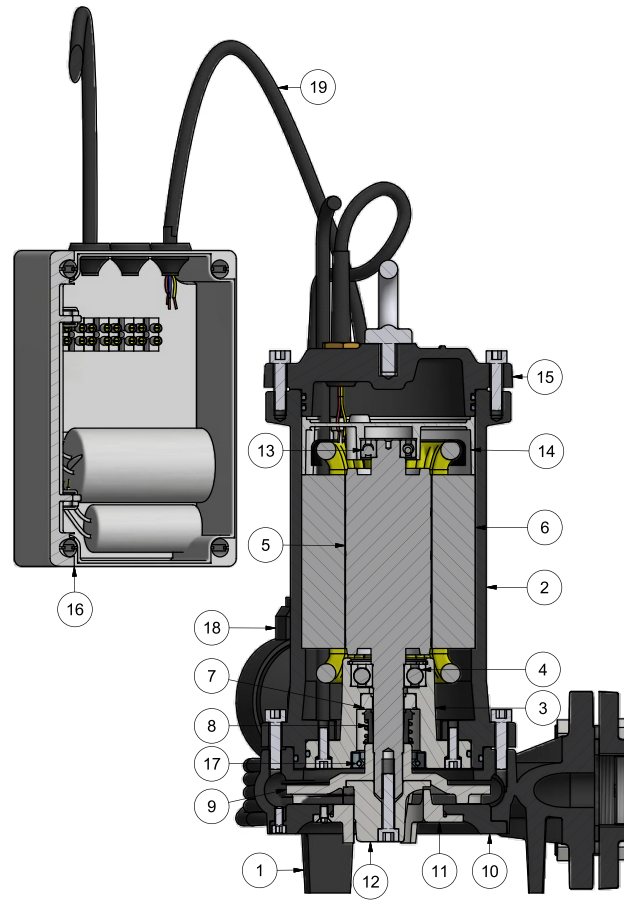

POS.	COMPONENT	MATERIALS	POS.	COMPONENT	MATERIALS
1	Body Pump	Cast Iron	13	Bearing	Steel
2	Motor Casing	Cast Iron	14	Top Engine Support	Aluminum
3	Rotor Support SGR	Cast Iron	15	Top Cover	Cast Iron
4	Bearing	Steel	16	Simple Cover board	
5	Rotor / Shaft	Steel and Aluminum / Stainless Steel	17	Lip Seals	Nitrile Rubber
6	Stator		18	Float	Neoprene Plastic
7	Mechanical Seal Fixe	Nitrile Rubber / Ceramics	19	Power Cable	Neoprene
8	Mechanical Seal Mobile	Graphite Steel			
9	Impeller	Cast Iron			
10	Bottom Cover	Cast Iron			
11	Crushed Dish	Stainless Steel			
12	Crusher	Stainless Steel			

DIMENSIONS AND WEIGHT

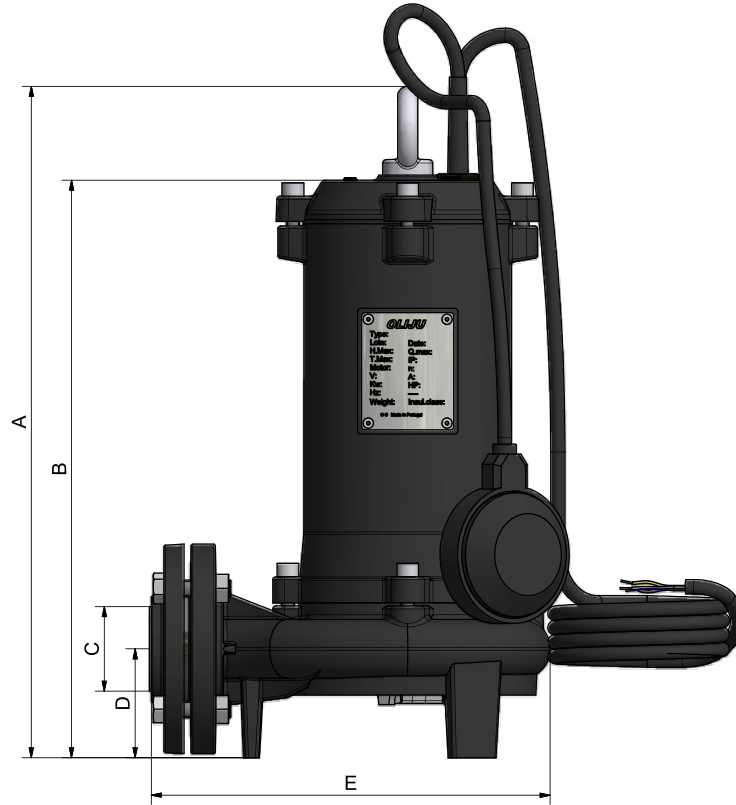

TYPE	DIMENSIONS (mm)							WEIGHT Kg
	A	B	C	D	ØE	ØF	G	
SGR 40.150	404	352	237	65	11	102	1½"	26,5
SGR 40.120								
SGR 50.220	470	415	294	95	13	110	2"	36